

DECLARATION OF GEO-TECHNICAL ENGINEER
 IT IS CERTIFIED THAT THE COMPREHENSIVE GED INVESTIGATION HAS BEEN PREPARED BY ME FOR DESIGN & CALCULATION OF FOUNDATION OF THE BUILDING. THE FOUNDATION OF THE BUILDING ESTIMATING THE BEARING CAPACITY OF THE SOIL ON WHICH FOUNDATION OF THE STRUCTURE WILL BE CONSTRUCTED.

Tusharaa Kaban
TUSHARABARAN PABARI
 M.E. (Structural)
 P-25, P. No. 10, Sector-24
 Engineering of M.C. No. C-1/107
 Environmental Geotechnical

SIGNATURE OF GEO-TECHNICAL ENGINEER

CERTIFICATE OF ARCHITECTS
 I HAVE REVIEWED THE ARCHITECTURAL DRAWINGS AND SPECIFICATIONS AND OTHER STRUCTURAL DETAILS OF THE PROPOSED BUILDING AT G.S. OR A.S. DAG NO. 833(P) & 837, COLONY, MOZA UDAPUR AND ALL NEARBY AREAS UNDER MADHYAMGRAM MUNICIPALITY, DIST. NORTH 24 PARGANAS UNDER MADHYAMGRAM MUNICIPALITY, HAVE BEEN PREPARED IN CONFORMITY WITH UNDER THE WEST BENGAL MUNICIPAL BUILDING RULES 2007. THIS ALSO TO CERTIFY THAT ALL RELEVANT NO SUCH AS FIRE & EMERGENCY SERVICE PERMIT/APPROPRIATE AUTHORITY/POLLUTION CONTROL BOARD/TELECOMMISSION/USE ALSO ENCLOSE WITH THE DRAWING FOR SEEKING APPROVAL OF THE PLAN TO CONSTRUCT/RECONSTRUCT/ADDITION TO ALTERATION OF THE BUILDING ON THE SAID PLOT.

V. Chaudh
V. Chaudh
 Architect
 Sectt. No. CR/80/1178

SIGNATURE OF ARCHITECTS

CERTIFICATE OF STRUCTURAL ENGINEER
 I HAVE REVIEWED THE STRUCTURAL DRAWINGS AND SPECIFICATIONS AND OTHER STRUCTURAL DETAILS OF THE PROPOSED BUILDING AT G.S. OR A.S. DAG NO. 833(P) & 837, COLONY, MOZA UDAPUR AND ALL NEARBY AREAS UNDER MADHYAMGRAM MUNICIPALITY, DIST. NORTH 24 PARGANAS UNDER MADHYAMGRAM MUNICIPALITY, HAVE BEEN PREPARED IN CONFORMITY WITH UNDER THE WEST BENGAL MUNICIPAL BUILDING RULES 2007. THIS ALSO TO CERTIFY THAT ALL RELEVANT NO SUCH AS FIRE & EMERGENCY SERVICE PERMIT/APPROPRIATE AUTHORITY/POLLUTION CONTROL BOARD/TELECOMMISSION/USE ALSO ENCLOSE WITH THE DRAWING FOR SEEKING APPROVAL OF THE PLAN TO CONSTRUCT/RECONSTRUCT/ADDITION TO ALTERATION OF THE BUILDING ON THE SAID PLOT.

Sumita Devi
SUMITA DEVI
 M.C.E. M.I.E. C.I.
 888/11/83

SIGNATURE OF STRUCTURAL ENGINEER

CERTIFIED THAT SHALL NOT ON A LATER DATE MAKE ANY ALTERATION TO THIS PLAN CERTIFIED THAT I HAVE GONE THROUGH THE BUILDING RULES FOR MADHYAMGRAM MUNICIPALITY AND ALSO ABIDE BY THESE RULES DURING AND AFTER CONSTRUCTION OF THE BUILDING.

SIGNATURE OF OWNER

1. NISH TRADecom PRIVATE LIMITED
 2. NISH TRADecom PRIVATE LIMITED
 3. NISH TRADecom PRIVATE LIMITED
 4. NIKHIL VINHAY PRIVATE LIMITED
 5. D-ANGESKY DEALERS PRIVATE LIMITED
 6. POWERFUL TRADecom PRIVATE LIMITED
 7. ACTUAL COMMERCIAL PRIVATE LIMITED
 8. LIPSHAKHANI DEALCHHARA PRIVATE LIMITED
 9. LIPSHAKHANI DEALCHHARA PRIVATE LIMITED
 10. LIPSHAKHANI DEALCHHARA PRIVATE LIMITED

Pragati Bhattacharya
Pragati Bhattacharya
 AUTHORIZED SIGNATORY

PROJECT
 PROPOSED 6-40' STORED INDUSTRIAL BUILDING PLAN OF COLONY, MOZA UDAPUR AND ALL NEARBY AREAS UNDER MADHYAMGRAM MUNICIPALITY, DIST. NORTH 24 PARGANAS UNDER MADHYAMGRAM MUNICIPALITY, STREET/ROAD ESSORE ROAD P.5 BARASAT DIST. NORTH 24 PARGANAS UNDER MADHYAMGRAM MUNICIPALITY

ARCHITECT:
 THE DESIGN CELL
 2A, COOPER STREET
 KOLKATA - 700 026

STRUCTURAL, ELECTROMECHANICAL CONSULTANTS:
 Designing Services CONSULTANTS PVT. LTD.
 Consulting Engineers
 150, Canal Road, Sector-24, Phase-2, Salt Lake, Kolkata-700064
 T: 91-9830248111 F: 91-9830248112
 www.designing-services.com

CORPORATION DRAWING

DRAWING TITLE:
 G.I.A. AT ROOF PLAN & BEAM/SLAB SCHEDULE

SCALE:
 1:100

FILE NO.:
 CR/80/1178

DATE:
 20/07/2023

DESIGNER:
 SUMITA DEVI

CHECKED BY:
 PRAGATI BHATTACHARYA

JOB NO.:
 307-11

DRG. NO.:
 S-INDUSTRIAL-CORP-A-34

REV. NO.:
 00

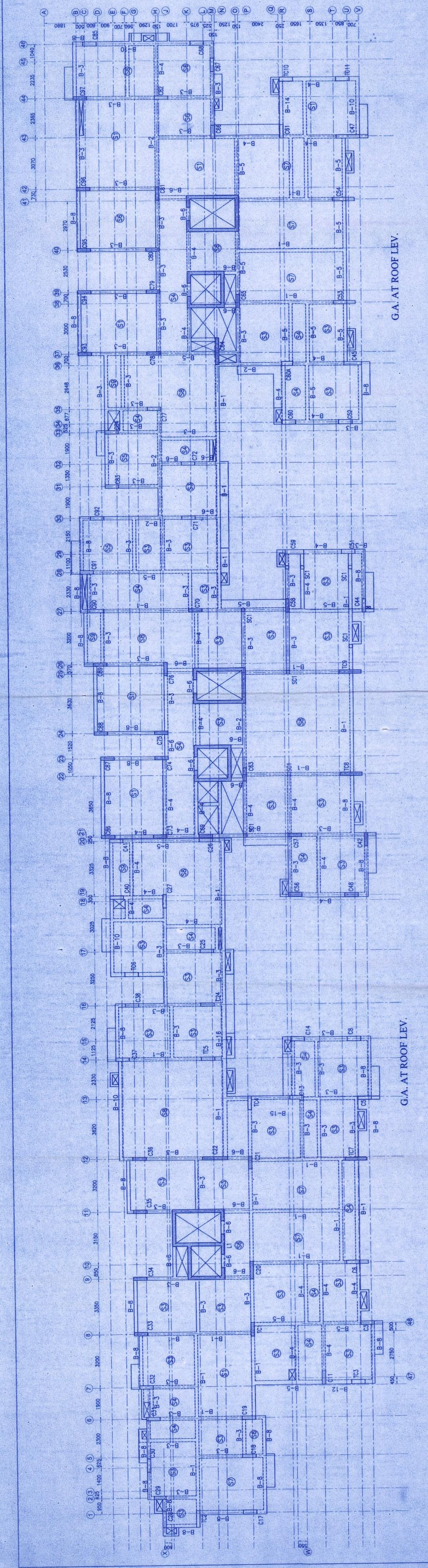

S.P. Khanna
S.P. Khanna
 Structural Reviewer
 CHANDI PRASAD KHANNA
 BE (Civil), M.E. (Struct), MIB (India)
 838-11/2

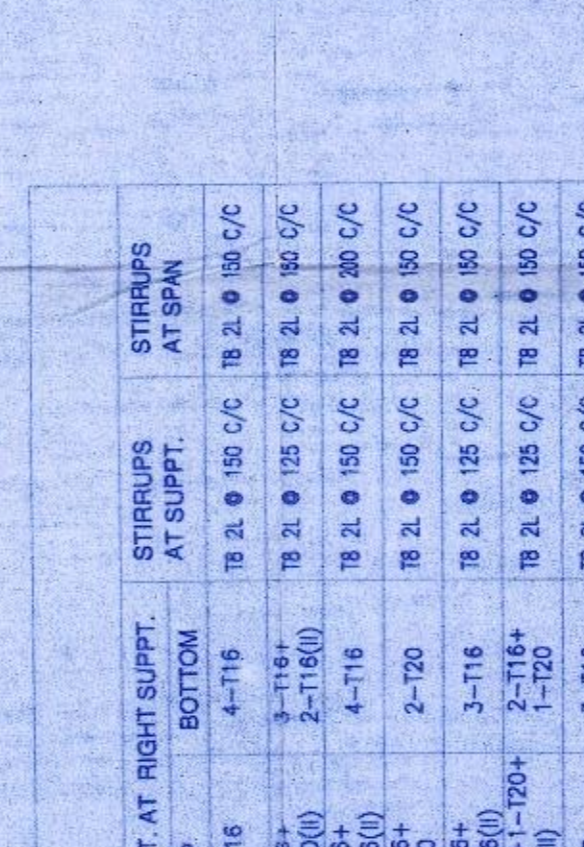
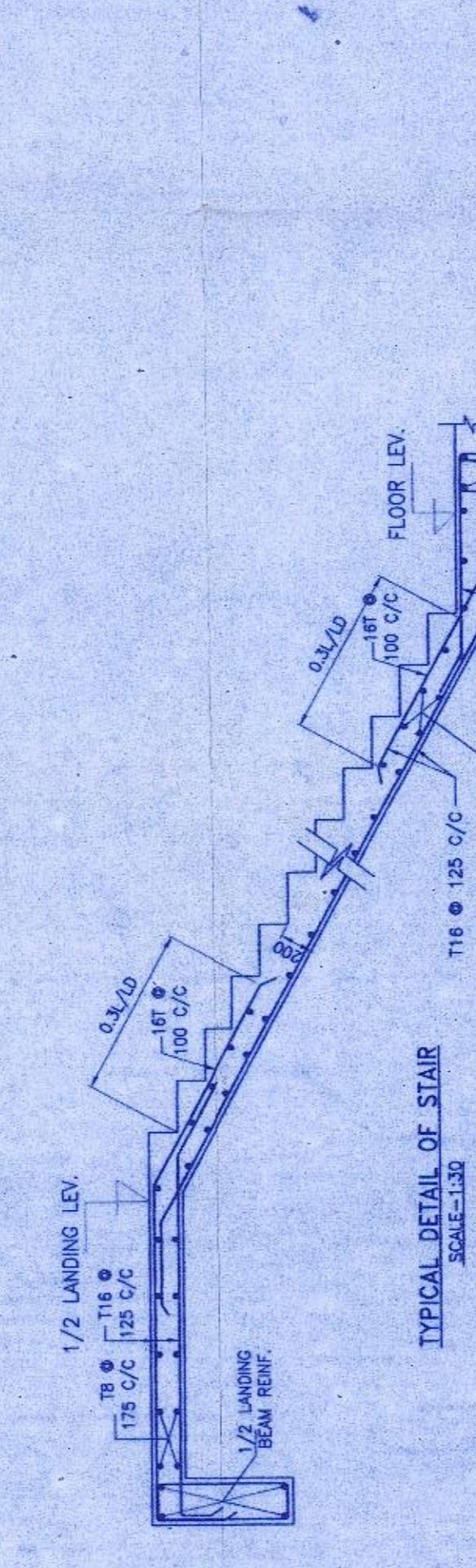

FLOOR BEAM SCHEDULE (GROUND FLOOR TO ROOF PLAN)
 GRADE OF CONCRETE - M30

BEAM MKO.	WIDE DEPTH	REINF. AT LEFT SUPPT.		REINF. AT SPAN		REINF. AT RIGHT SUPPT.		STIRRUPS AT SUPPT.	STIRRUPS AT SPAN
		TOP	BOTTOM	TOP	BOTTOM	TOP	BOTTOM		
B-1	250 x 450	4-16	4-16	4-16	4-16	4-16	4-16	18 2.0 150 C/C	18 2.0 150 C/C
B-2	250 x 750	3-16+	3-16+	3-16+	3-16+	3-16+	3-16+	18 2.0 125 C/C	18 2.0 150 C/C
B-3	250 x 600	4-16+	4-16+	4-16	4-16	4-16	4-16	18 2.0 150 C/C	18 2.0 150 C/C
B-4	250 x 600	3-16+	3-16+	3-16	3-16	3-16	3-16	18 2.0 150 C/C	18 2.0 150 C/C
B-5	250 x 600	2-16+1-20+	2-16+1-20+	2-16	2-16	2-16	2-16	18 2.0 125 C/C	18 2.0 150 C/C
B-6	250 x 500	3-16	3-16	3-16	3-16	3-16	3-16	18 2.0 150 C/C	18 2.0 150 C/C
B-7	400 x 500	3-16(0)	3-16(0)	3-16	3-16	3-16	3-16	18 2.0 150 C/C	18 2.0 150 C/C

(0) = 2ND LAYER

FLOOR SLAB SCHEDULE M30 (GROUND FLOOR TO POOL PLAN)

SLAB	SLAB MKO THICKNESS	SHOTTER DIR. SUPPT. (DP)	SHOTTER DIR. SUPPT. (BP)	LONGER DIR. SUPPT. (TOP)	LONGER DIR. SUPPT. (BOT)	DISTRIBUTION
S1	175	110 150 C/C	110 200 C/C	110 200 C/C	110 200 C/C	18 300 C/C
S2	175	110 150 C/C	110 150 C/C	110 175 C/C	110 175 C/C	18 300 C/C
S3	150	110 150 C/C	110 150 C/C	110 150 C/C	110 150 C/C	18 300 C/C
S4	125	110 150 C/C	110 150 C/C	110 200 C/C	110 200 C/C	18 300 C/C
S5	125	110 150 C/C	110 150 C/C	110 200 C/C	110 200 C/C	18 300 C/C
S6	125	110 150 C/C	110 150 C/C	110 150 C/C	110 150 C/C	18 300 C/C
S7	125	110 150 C/C	110 150 C/C	110 175 C/C	110 175 C/C	18 300 C/C
S8	175	110 150 C/C	110 150 C/C	110 200 C/C	110 200 C/C	18 300 C/C
S9	110	110 200 C/C	110 200 C/C	110 200 C/C	110 200 C/C	18 300 C/C

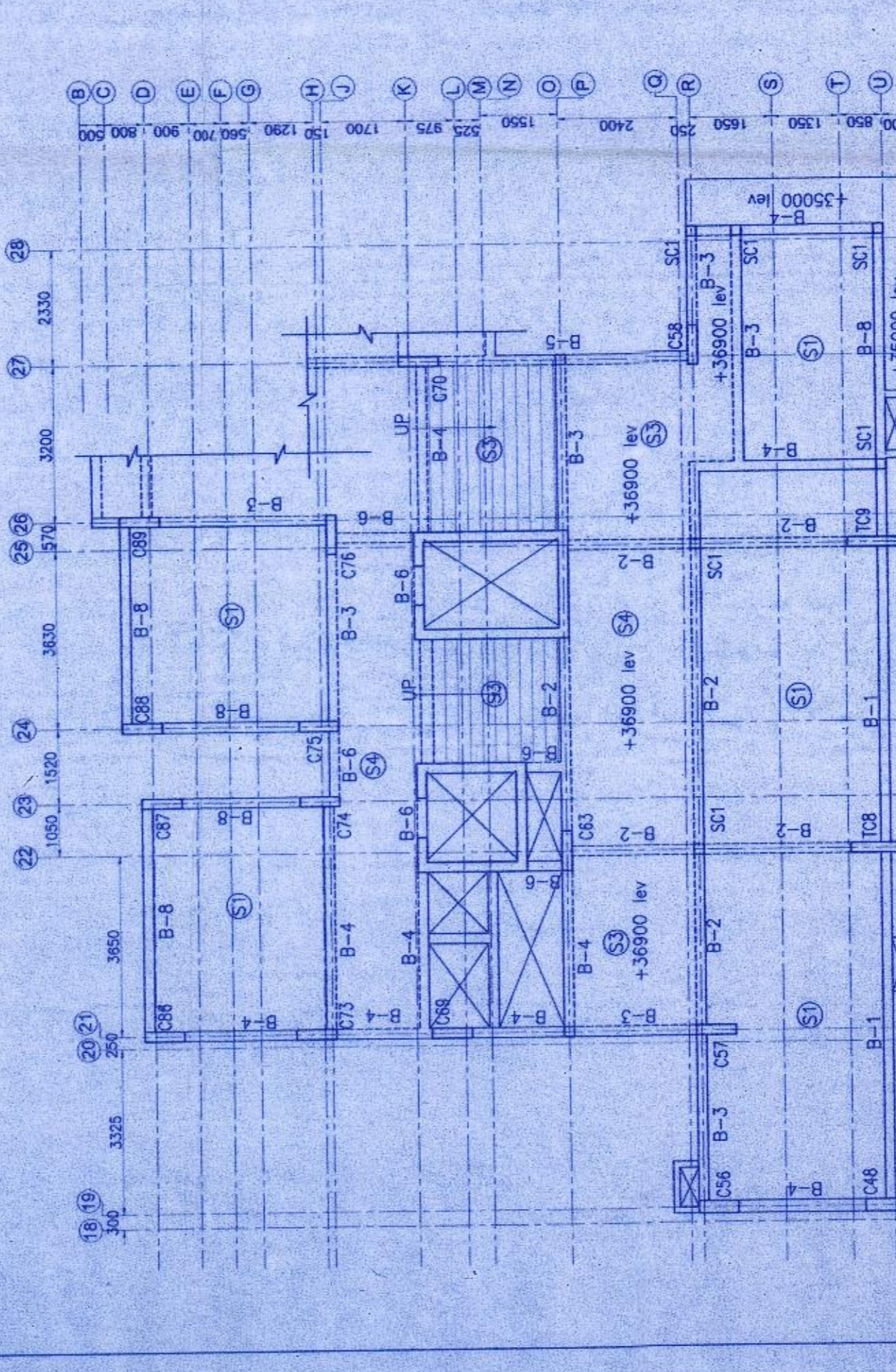

THE DESIGN CELL
 2A, COOPER STREET
 KOLKATA - 700 026

STRUCTURAL, ELECTROMECHANICAL CONSULTANTS:
 Designing Services CONSULTANTS PVT. LTD.
 Consulting Engineers
 150, Canal Road, Sector-24, Phase-2, Salt Lake, Kolkata-700064
 T: 91-9830248111 F: 91-9830248112
 www.designing-services.com

CORPORATION DRAWING

DRAWING TITLE:
 G.I.A. AT ROOF PLAN & BEAM/SLAB SCHEDULE

SCALE:
 1:100

FILE NO.:
 CR/80/1178

DATE:
 20/07/2023

DESIGNER:
 SUMITA DEVI

CHECKED BY:
 PRAGATI BHATTACHARYA

JOB NO.:
 307-11

DRG. NO.:
 S-INDUSTRIAL-CORP-A-34

REV. NO.:
 00